

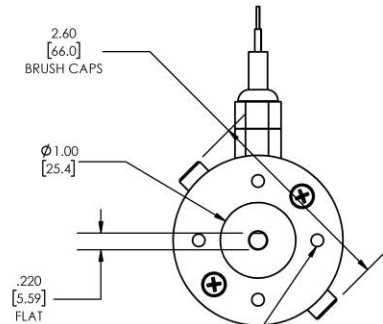

# REVERSIBLE BRUSHED DC MOTOR

**Model Number:**

**MMP D22-490A-24V**

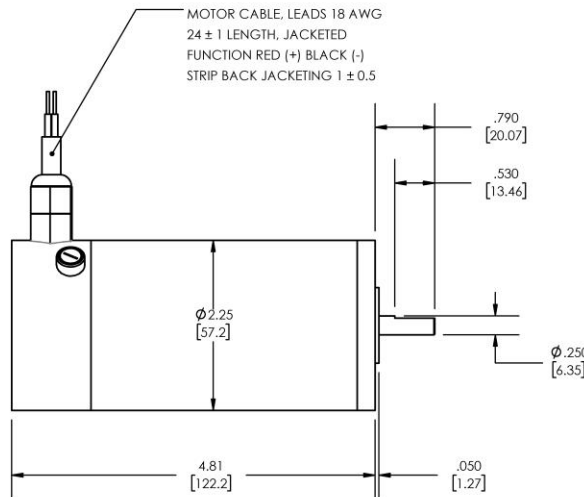

(4) M5 x 0.8 THREADED MOUNTING HOLES  
▽ 0.350 [8.89] ON A Ø 1.570 [39.88] BC  
SPACED 90° APART

DIMENSIONS ARE INCHES [MM] UNLESS OTHERWISE STATED

DC MOTOR PERFORMANCE PARAMETERS:	VALUE	UNITS	TOLERANCE
Rated DC Voltage	24	DC VOLTS	----
Rated Continuous Current	10.1	AMPERES	----
No-Load Speed	7059	RPM	MAX
Rated Speed	5923	RPM	+/- 15%
Rated Continuous Power Out	190	WATTS	+/- 15%
Rated Continuous Torque	43	OZ-IN	----
Peak Torque (motor only)	198	OZ-IN	----
No-Load Current	0.94	AMPERES	MAX
Back EMF Constant (Ke)	3.4	V/KRPM	+/- 10%
Torque Constant (Kt)	4.7	OZ-IN/AMP	+/- 10%
DC Armature Resistance	0.38	OHMS	+/- 15%
Armature Inductance	0.31	mH	+/- 15%
Armature temperature	155	DEG. C	MAX

**NOTES:**

- ENCODER & BRAKE OPTIONS AVAILABLE – [FOLLOW THIS LINK FOR DETAILS](#)
- NEMA MOUNTING FLANGE OPTION AVAILABLE – [FOLLOW THIS LINK FOR DETAILS](#)

**MIDWEST MOTION PRODUCTS, INC**

**DESIGN, MANUFACTURING & DISTRIBUTION - MOTION CONTROL EQUIPMENT**

[www.midwestmotion.com](http://www.midwestmotion.com)

email: [sales@midwestmotion.com](mailto:sales@midwestmotion.com)